

ECON® Bourdon tube pressure gauge Type 335 bottom connection brass

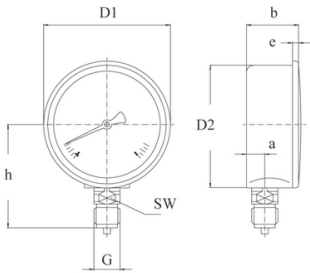

Characteristics

- Type:** 335
- Model:** Bourdon tube pressure gauge
- Blow-out included:** No
- Pressure gauge attachment:** Direct
- Process connection:** External thread
- Cabinet material:** Plastic
- Process connection material:** Brass

Characteristics [2]

- Window material:** Plastic
- Material dial:** Plastic
- Protection class:** IP65
- Medium temperature:** 0 / 60 °C
- Ambient temperature:** -20 / 60 °C

Cabinet diameter	G	D1	D2	b	e	a	sw	h
mm	BSPP	mm	mm	mm	mm	mm	mm	mm
R63	1/4"	68	63	27	5	11.5	14	54

Cabinet diameter	Measuring range	Pressure unit	Secondary scale division	Pressure unit secondary scale	Accuracy class	Cabinet filling fluid	Connection location	Size process connection	Maximum overpressure	Article
mm									bar	
63	0 / 4	bar	0 - 60	psi	2.5 %	Glycerin	Below	1/4" BSPP[G]	4	WI003354AH-44210
63	0 / 6	bar	0 - 10	psi	2.5 %	Glycerin	Below	1/4" BSPP[G]	6	WI003354AI4-4210
63	0 / 10	bar	0 - 160	psi	2.5 %	Glycerin	Below	1/4" BSPP[G]	10	EC003353G2-C5130
63	0 / 25	bar	0 - 400	psi	2.5 %	Glycerin	Below	1/4" BSPP[G]	25	WI003354AL-44210

Disclaimer: The content of this document has been composed with the utmost care. However, it is possible that certain information changes over time, becomes inaccurate or incomplete. ERIKS does not guarantee that the information provided on this document is up to date, accurate and complete; the information provided is not intended to be advice. ERIKS shall never be liable for damage resulting from the use of the information provided.