

## ECON® Bourdon tube pressure gauge Type 1401C rear connection brass front flange

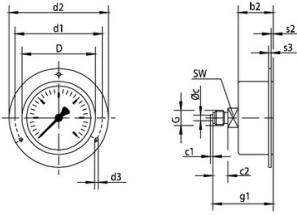

### Characteristics

- Type:** 1401C
- Model:** Bourdon tube pressure gauge
- Blow-out included:** No
- Pressure gauge attachment:** Front flange
- Process connection:** External thread
- Material mounting flange:** Stainless steel
- Process connection material:** Brass
- Window material:** Acrylic
- Protection class:** IP54
- Medium temperature:** 0 / 50 °C
- Ambient temperature:** 0 / 50 °C

### Application

- Light industry.
- Pneumatics.
- Installation technique.

### Technical Information

- Suitable for gases and liquids that do not affect the brass measuring system.
- Measuring ranges according to EN 837-1.
- Equipped with front flange for panel mounting.

### Options

- Double scale for example in bar/psi.
- Damping screw in connection.
- Dial according to customer specification for example company logo.

Cabinet diameter	G	D	b2	c	c1	c2	d1	d2	d3	g1	s2	s3	SW	Weight
	BSPP	mm	mm	mm	mm	mm	mm	mm	mm	mm	mm	mm	mm	kg
R63	1/4"	53	32	5	2	13	62	75	85	3.6	1.5	2	14	0.13

Cabinet diameter mm	Measuring range	Pressure unit	Accuracy class	Cabinet filling fluid	Connection location	Size process connection	Cabinet material	Material dial	Maximum overpressure bar	Article
63	-1 / 0	bar	1.6 %	None	Back centric	1/4" BSPP[G]	Stainless steel 304	Aluminium	0	685157
63	0 / 1.6	bar	1.6 %	None	Back centric	1/4" BSPP[G]	Stainless steel 304	Aluminium	2	685111
63	0 / 2.5	bar	1.6 %	None	Back centric	1/4" BSPP[G]	Stainless steel 304	Aluminium	3	685130
63	0 / 16	bar	1.6 %	None	Back centric	1/4" BSPP[G]	Stainless steel 304	Aluminium	20	685125

Disclaimer: The content of this document has been composed with the utmost care. However, it is possible that certain information changes over time, becomes inaccurate or incomplete. ERIKS does not guarantee that the information provided on this document is up to date, accurate and complete; the information provided is not intended to be advice. ERIKS shall never be liable for damage resulting from the use of the information provided.