



ECON® Bourdon tube pressure gauge Type 1334 rear connection brass

Characteristics

- Type:** 1334
- Model:** Bourdon tube pressure gauge
- Blow-out included:** No
- Pressure gauge attachment:** Direct
- Process connection:** External thread
- Process connection material:** Brass
- Window material:** Plastic
- Material dial:** Plastic
- Protection class:** IP54
- Medium temperature:** 0 / 60 °C
- Ambient temperature:** -20 / 60 °C

Application

- Light industry.
- Pneumatics.
- Installation technology.

Technical Information

- Suitable for gases and liquids that do not affect the brass measuring system.
- Measuring ranges according to EN 837-1.

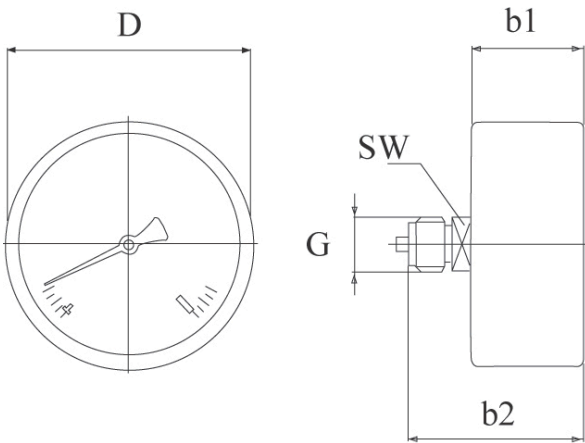

Size table:

Cabinet diameter	G	b1	b2	D	SW	Weight
		mm	mm	mm	mm	kg
R40	1/8"	26	44	40	14	0.07
R50	1/4"	27	48	50	14	0.1
R63	1/4"	27	47	63	14	0.15

Cabinet diameter	Measuring range	Pressure unit	Pressure unit secondary scale	Accuracy class	Cabinet filling fluid	Connection location	Size process connection	Cabinet material	Maximum overpressure	Article
mm									bar	
40	-1 / 0	bar		2.5 %	None	Back centric	1/8" BSPP[G]	Plastic	0	EC0133411B4130
40	0 / 4	bar		2.5 %	None	Back centric	1/8" BSPP[G]	Plastic	4	EC013341E2B4130
40	0 / 6	bar		2.5 %	None	Back centric	1/8" BSPP[G]	Plastic	6	EC013341F2B4130
40	0 / 7	bar	psi	2.5 %	None	Back centric	1/8" NPT	Plastic	7	WI013342YU-A4120
40	0 / 10	bar		2.5 %	None	Back centric	1/8" BSPP[G]	Plastic	10	EC013341G2B-4130
50	0 / 6	bar		2.5 %	None	Back centric	1/4" BSPP[G]	Plastic	6	EC013342FID-4130
50	0 / 10	bar		2.5 %	None	Back centric	1/4" BSPP[G]	Plastic	10	EC013342GID-4130
50	0 / 12	bar		2.5 %	None	Back centric	1/8" BSPP[G]	Stainless steel 304	12	WI34200062
63	-1 / 0	bar		2.5 %	None	Back centric	1/4" BSPP[G]	Plastic	0	EC01334312D-4130
63	0 / 1	bar		2.5 %	None	Back centric	1/4" BSPP[G]	Plastic	1	EC013343B2D-4130
63	0 / 1.6	bar		2.5 %	None	Back centric	1/4" BSPP[G]	Stainless steel 304	1.6	WI47992794

Disclaimer: The content of this document has been composed with the utmost care. However, it is possible that certain information changes over time, becomes inaccurate or incomplete. ERIKS does not guarantee that the information provided on this document is up to date, accurate and complete; the information provided is not intended to be advice. ERIKS shall never be liable for damage resulting from the use of the information provided.

Cabinet diameter	Measuring range	Pressure unit	Pressure unit secondary scale	Accuracy class	Cabinet filling fluid	Connection location	Size process connection	Cabinet material	Maximum overpressure	Article
mm									bar	
63	0 / 2.5	bar		2.5 %	None	Back centric	1/4" BSPP(G)	Stainless steel 304	2.5	EC013343D2D-1130
63	0 / 4	bar		2.5 %	None	Back centric	1/4" BSPP(G)	Plastic	4	EC013343E2D-4130
63	0 / 10	bar		2.5 %	None	Back centric	1/4" BSPP(G)	Plastic	10	EC013343G2D-4130

Disclaimer: The content of this document has been composed with the utmost care. However, it is possible that certain information changes over time, becomes inaccurate or incomplete. ERIKS does not guarantee that the information provided on this document is up to date, accurate and complete; the information provided is not intended to be advice. ERIKS shall never be liable for damage resulting from the use of the information provided.