

ECON® Water separator Type: 1085E steel flange

Characteristics

- Type:** 1085E
- Max. operating pressure:** 16 bar
- Housing material:** Steel
- Material quality:** 1.0345
- Suitable for compressed air:** Yes
- Suitable for steam:** Yes

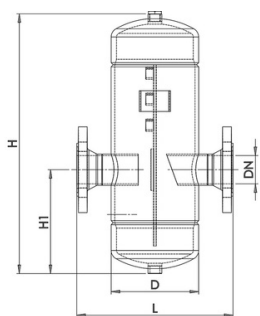

DN	H	H1	L	D	Weight
mm	mm	mm	mm	mm	[kg]
40	500	200	300	168	21
50	500	200	300	168	22,5
65	650	260	400	220	39
80	650	260	450	324	57
100	825	330	500	324	74,5

Pressure max.	Temperature max.	Temperature min.
13 bar	200°C	0°C

Connection	Nominal inner diameter	Pressure rating	Maximum medium temperature (continuous) °C	Article
Flange	DN50	PN16	200	EC010850050KC24E
Flange	DN65	PN16	200	EC010850065KC24E

Disclaimer: The content of this document has been composed with the utmost care. However, it is possible that certain information changes over time, becomes inaccurate or incomplete. ERIKS does not guarantee that the information provided on this document is up to date, accurate and complete; the information provided is not intended to be advice. ERIKS shall never be liable for damage resulting from the use of the information provided.