



## ECON® Pressure gauge siphon pipe Type 350 steel pigtail external thread

### Characteristics

**Type:** 350

**Shape:** Pigtail

**Process connection:** External thread

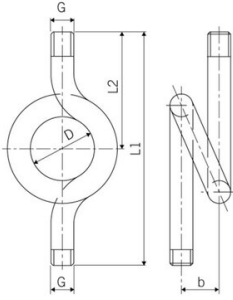

Model	Material	Material quality	Size process connection	Nominal inner diameter	Connection instrument side	Size instrument connection	With tension socket	Pressure rating	Article
Pressure gauge siphon pipe	Steel, phosphated	1.0345	1/2" BSP	DN15	External thread	1/2" BSP	No	PN25	SY0035001/2CCCB
Pressure gauge siphon pipe	Steel, phosphated	1.0345	1/4" BSP	DN8	External thread	1/4" BSP	No	PN25	SY0035001/4CCCB
Pressure gauge siphon pipe	Steel, phosphated	1.0345	3/8" BSP	DN10	External thread	3/8" BSP	No	PN25	SY0035003/8C-CCB

Disclaimer: The content of this document has been composed with the utmost care. However, it is possible that certain information changes over time, becomes inaccurate or incomplete. ERIKS does not guarantee that the information provided on this document is up to date, accurate and complete; the information provided is not intended to be advice. ERIKS shall never be liable for damage resulting from the use of the information provided.