

ECON® Mudbox strainer Type: 1188 Cast iron EN-JL1040 Angle Pattern Flange



Characteristics

- Type:** 1188
- Norm:** EN (DIN)
- Construction type:** Angle Pattern
- Housing material:** Cast iron
- Material quality:** EN-JL1040
- Surface protection:** Coated
- Connection:** Flange
- Drain connection:** Yes
- Material cover gasket:** NBR
- Material drain plug:** Brass
- Material bow nut:** Brass

Application

- Pump and system protection for applications on land or at sea
- Medium: [salt] water

Technical Information

- Standard fitted with bow nuts.
- With drain plug as standard.
- Horizontal piping.
- Suitable for suction and delivery piping.

Options

- Available in other materials: bronze, CuNiFe, steel [welded] and stainless steel [welded]
- Available with other connection types
- Available with other perforations

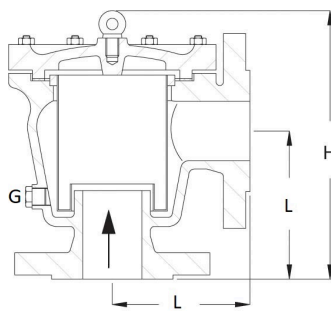
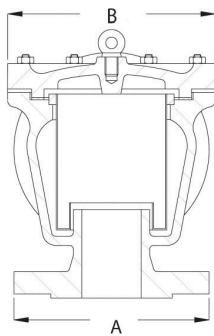

Size table:

DN	A mm	B mm	H mm	L mm	G	Weight kg
DN40	150	145	222	125	1/2"	9
DN50	165	175	241	135	1/2"	13
DN100	220	270	343	195	1/2"	30
DN150	285	385	456	270	3/4"	66

Pressure rating	Temperature range
PN4	-10°C / +50°C

Nominal inner diameter	Pressure rating	Pressure rating flange	Face to Face length mm	With filter element	Mesh width	Flow direction	Filter element material	Article
DN40	PN4	PN10	125	Yes	8 mm	Rising inlet, horizontal outlet	Stainless steel	EC011880040G8R0K

Disclaimer: The content of this document has been composed with the utmost care. However, it is possible that certain information changes over time, becomes inaccurate or incomplete. ERIKS does not guarantee that the information provided on this document is up to date, accurate and complete; the information provided is not intended to be advice. ERIKS shall never be liable for damage resulting from the use of the information provided.

Nominal inner diameter	Pressure rating	Pressure rating flange	Face to Face length mm	With filter element	Mesh width	Flow direction	Filter element material	Article
DN50	PN4	PN10	135	Yes	8 mm	Rising inlet, horizontal outlet	Stainless steel	EC011880050G8R0K
DN100	PN4	PN10	195	Yes	8 mm	Rising inlet, horizontal outlet	Stainless steel	EC011880100G8R0K
DN150	PN4	PN10	270	Yes	8 mm	Rising inlet, horizontal outlet	Stainless steel	EC011880150G8R0K

Disclaimer: The content of this document has been composed with the utmost care. However, it is possible that certain information changes over time, becomes inaccurate or incomplete. ERIKS does not guarantee that the information provided on this document is up to date, accurate and complete; the information provided is not intended to be advice. ERIKS shall never be liable for damage resulting from the use of the information provided.