



ECON® Ball valve Type: 1604 Brass External thread (BSPP) PN30

Characteristics

- Type:** 1604
- Norm:** EN (DIN)
- Construction type:** 2-way
- Housing construction:** 2-part
- Housing material:** Brass
- Material quality:** CW617N
- Surface protection:** Nickel-plated
- Connection:** External thread (BSPP)
- Secondary spindle seal material:** HNBR
- Actuator material:** Aluminium

Application

- HVAC, water and compressed air systems.

Technical Information

- Connections with male threads in accordance with EN-ISO 228-1.
- Ball valve with floating ball.
- Version with lever.
- Available in sizes ranging from 1/2" to 2".
- Pressure class PN30.

Construction

- Two-piece housing construction.
- Design in accordance with EN 13828.
- Full bore.
- Face-to-face dimension according to manufacturer's standard.

Options

- Available with extended spindle for insulation.

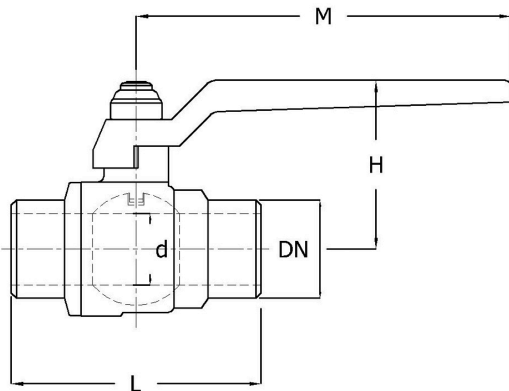

Size table:

DN	d	L	H	M	Weight
	mm	mm	mm	mm	kg
1/2" [15]	15	58.5	41	90	0.21
3/4" [20]	20	67.5	46	90	0.33
1" [25]	25	76.5	54.5	105	0.51
1.1/4" [32]	32	86.7	66	105	0.82
1.1/2" [40]	40	100	72	120	1.11
2" [50]	50	118	87	140	2.01

Size	Pressure class	Pressure and temperature range			[°C]
		-20	90	130	
1/2" - 2"	PN30	30	12	4	[bar]

Nominal inner diameter	Standard thread connection	Pressure rating	Face to Face norm	Manual operation	Bore	Material ball	Seat material	Spindle material	Primary spindle seal material	Article
1/2" [15]	ISO 228-1	PN30	Manufacturer standard	Handle	Full bore	CW614N chromed	PTFE	CW614N	PTFE	13244365
3/4" [20]	ISO 228-1	PN30	Manufacturer standard	Handle	Full bore	CW614N chromed	PTFE	CW614N	PTFE	13244367

Disclaimer: The content of this document has been composed with the utmost care. However, it is possible that certain information changes over time, becomes inaccurate or incomplete. ERIKS does not guarantee that the information provided on this document is up to date, accurate and complete; the information provided is not intended to be advice. ERIKS shall never be liable for damage resulting from the use of the information provided.

Ball Valves | Ball valves with threaded connection

Nominal inner diameter	Standard thread connection	Pressure rating	Face to Face norm	Manual operation	Bore	Material ball	Seat material	Spindle material	Primary spindle seal material	Article
1" [25]	ISO 228-1	PN30	Manufacturer standard	Handle	Full bore	CW614N chromed	PTFE	CW614N	PTFE	13244368
1.1/4" [32]	ISO 228-1	PN30	Manufacturer standard	Handle	Full bore	CW614N chromed	PTFE	CW614N	PTFE	13244369
1.1/2" [40]	ISO 228-1	PN30	Manufacturer standard	Handle	Full bore	CW614N chromed	PTFE	CW614N	PTFE	13244370
2" [50]	ISO 228-1	PN30	Manufacturer standard	Handle	Full bore	CW614N chromed	PTFE	CW614N	PTFE	13244372

Disclaimer: The content of this document has been composed with the utmost care. However, it is possible that certain information changes over time, becomes inaccurate or incomplete. ERIKS does not guarantee that the information provided on this document is up to date, accurate and complete; the information provided is not intended to be advice. ERIKS shall never be liable for damage resulting from the use of the information provided.