

ECON® Tubular level gauge fig. 1590D steel reflex body double connection male thread

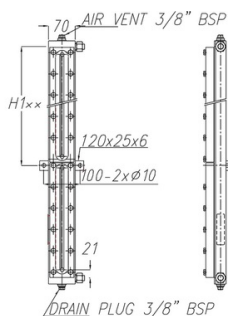

Characteristics

Type: 1590D
Housing material: Steel
Connection type: Double
Connecting direction: Right
Pressure rating: PN10
Material level body: S235JRH
Material of cap: Stainless steel
Material glass: Borosilicate

Characteristics [2]

Seal material: Novus 30
Lockable: No
With drain: Yes
With de-aeration: No
Self-locking: No
Self-venting: Yes
Maximum medium temperature (continuous): 90 °C

| Standard FtF | | | | | | | | | | | | | | |
|--------------|------|------|------|------|------|------|------|------|------|------|------|------|------|------|
| 230 | 290 | 350 | 460 | 520 | 580 | 640 | 700 | 750 | 810 | 870 | 930 | 990 | 1050 | 1100 |
| 1160 | 1220 | 1280 | 1340 | 1400 | 1450 | 1510 | 1570 | 1630 | 1690 | 1750 | 1800 | 1860 | 1920 | 1980 |
| 2040 | 2100 | 2150 | 2210 | 2270 | 2330 | 2390 | 2450 | 2500 | 2560 | 2620 | 2680 | 2740 | 2800 | 2850 |
| 2910 | 2970 | 3030 | 3090 | 3150 | 3190 | 3250 | 3310 | 3370 | 3430 | 3490 | 3550 | 3610 | 3670 | 3730 |
| 3790 | 3850 | | | | | | | | | | | | | |

Note: in case of order always inform us about the FtF dimension

| Max oper. press. | Max. temperature |
|------------------|------------------|
| 10bar(g) | 90 °C |

| Model | Connection | Height mm | Article |
|------------------|----------------|--------------|----------|
| Level gauge body | Quick Coupling | 290 | 12712239 |
| Level gauge body | Quick Coupling | 350 | 12712240 |
| Level gauge body | Quick Coupling | 460 | 12712241 |
| Level gauge body | Quick Coupling | 580 | 12712284 |
| Level gauge body | Quick Coupling | 640 | 12712285 |
| Level gauge body | Quick Coupling | 640 | 12562758 |
| Level gauge body | Quick Coupling | 700 | 12712243 |
| Level gauge body | Quick Coupling | 700 | 12712286 |
| Level gauge body | Quick Coupling | 810 | 12712244 |
| Level gauge body | Quick Coupling | 810 | 12712287 |
| Level gauge body | Quick Coupling | 870 | 12712245 |
| Level gauge body | Quick Coupling | 870 | 12712288 |
| Level gauge body | Quick Coupling | 930 | 12712247 |

Disclaimer: The content of this document has been composed with the utmost care. However, it is possible that certain information changes over time, becomes inaccurate or incomplete. ERIKS does not guarantee that the information provided on this document is up to date, accurate and complete; the information provided is not intended to be advice. ERIKS shall never be liable for damage resulting from the use of the information provided.

| Model | Connection | Height mm | Article |
|------------------|----------------|--------------|----------|
| Level gauge body | Quick Coupling | 1050 | 12712248 |
| Level gauge body | Quick Coupling | 1100 | 12712289 |
| Level gauge body | Quick Coupling | 1100 | 12712249 |
| Level gauge body | Quick Coupling | 1220 | 12712250 |
| Level gauge body | Quick Coupling | 1280 | 12712251 |
| Level gauge body | Quick Coupling | 1340 | 12712252 |
| Level gauge body | Quick Coupling | 1400 | 12712253 |
| Level gauge body | Quick Coupling | 1450 | 12712254 |
| Level gauge body | Quick Coupling | 1510 | 12712290 |
| Level gauge body | Quick Coupling | 1510 | 12712255 |
| Level gauge body | Quick Coupling | 1570 | 12712256 |
| Level gauge body | Quick Coupling | 1630 | 12712257 |
| Level gauge body | Quick Coupling | 1690 | 12712258 |
| Level gauge body | Quick Coupling | 1690 | 12712291 |
| Level gauge body | Quick Coupling | 1750 | 12712259 |
| Level gauge body | Quick Coupling | 1800 | 12712260 |
| Level gauge body | Quick Coupling | 1860 | 12712292 |
| Level gauge body | Quick Coupling | 1920 | 12712262 |
| Level gauge body | Quick Coupling | 1980 | 12712263 |
| Level gauge body | Quick Coupling | 2040 | 12712293 |
| Level gauge body | Quick Coupling | 2040 | 12712264 |
| Level gauge body | Quick Coupling | 2150 | 12712265 |
| Level gauge body | Quick Coupling | 2210 | 12712266 |
| Level gauge body | Quick Coupling | 2270 | 12712267 |
| Level gauge body | Quick Coupling | 2330 | 12712268 |
| Level gauge body | Quick Coupling | 2390 | 12712269 |
| Level gauge body | Quick Coupling | 2450 | 12712270 |
| Level gauge body | Quick Coupling | 2500 | 12712271 |
| Level gauge body | Quick Coupling | 2560 | 12712272 |
| Level gauge body | Quick Coupling | 2620 | 12712273 |
| Level gauge body | Quick Coupling | 2680 | 12712294 |
| Level gauge body | Quick Coupling | 2680 | 12712274 |
| Level gauge body | Quick Coupling | 2740 | 12712275 |
| Level gauge body | Quick Coupling | 2800 | 12712276 |
| Level gauge body | Quick Coupling | 2970 | 12712278 |
| Level gauge body | Quick Coupling | 3030 | 12712279 |
| Level gauge body | Quick Coupling | 3150 | 12712280 |
| Level gauge body | Quick Coupling | 3320 | 12712281 |
| Level gauge body | Quick Coupling | 3500 | 12712282 |
| Level gauge body | Quick Coupling | 3670 | 12712283 |

Disclaimer: The content of this document has been composed with the utmost care. However, it is possible that certain information changes over time, becomes inaccurate or incomplete. ERIKS does not guarantee that the information provided on this document is up to date, accurate and complete; the information provided is not intended to be advice. ERIKS shall never be liable for damage resulting from the use of the information provided.