

## ECON® Water separator Type: 1089E steel flange

### Characteristics

- Type:** 1089E  
**Max. operating pressure:** 40 bar  
**Housing material:** Steel  
**Material quality:** 1.0345  
**Suitable for compressed air:** Yes  
**Suitable for steam:** Yes

### Application

- Steam installations. Compressed air systems.

### Technical Information

- Standard PN40 flanging. Below connection for 1/2" BSPT condensate drain. Above connection for pressure gauge or 1/2" BSPT vent.

### Operating Principle

- Moisture in the systems causes excessive wear and water hammer. A water separator, mounted for example for control valves and measuring instruments, effectively collects any moisture that may be present, which is discharged via a steam trap to be mounted underneath. At the top there is a 1/2" BSP connection for mounting a pressure gauge, which can be equipped with a syphon tube or a vent valve. The service life of valuable equipment such as control valves, flow meters, etc. is significantly extended by the use of water separators and the exact function is better maintained.

### Options

- Flanges in accordance with ANSI B 16.5, class 150 and 300. Complete version in stainless steel. Larger dimensions on request.

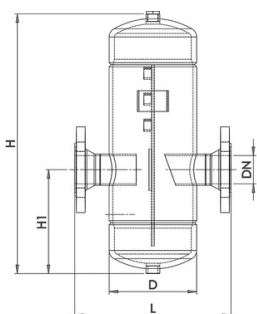

DN mm	H mm	HI mm	L mm	D mm	Weight [kg]
15	350	140	180	90	6,3
20	350	140	230	90	6,9
25	375	150	230	141	12,5
32	450	180	250	141	15,7
40	500	200	300	168	21,5
50	500	200	300	168	22
65	650	260	400	220	40,5
80	650	260	450	324	63
100	825	330	500	324	83
125	825	330	500	324	88,5

max. press.	max. temp.	min. temp.
30 bar	250°C	0°C

Connection	Nominal inner diameter	Pressure rating	Maximum medium temperature [continuous] °C	Article
Flange	DN20	PN40	250	EC010890020KC34E
Flange	DN40	PN40	250	EC010890040KC34E
Flange	DN80	PN40	250	EC010890080KC34E

Disclaimer: The content of this document has been composed with the utmost care. However, it is possible that certain information changes over time, becomes inaccurate or incomplete. ERIKS does not guarantee that the information provided on this document is up to date, accurate and complete; the information provided is not intended to be advice. ERIKS shall never be liable for damage resulting from the use of the information provided.