



STAUFF Clamp body PP-R polypropylene for elastomer insert Heavy series

Characteristics

Series: Heavy

Colour: Black

Profile: Elastomer insert

Tension clearance: No

DIN Standard: DIN 3015-2

Size table:

Group	H mm	L1 mm	L2 mm	Width mm
4S	46.5	70	45	30.5
5S	58	85	60	30.5
6S	87	115	90	45
7S	120	154	122	60
8S	168	208	168	80
9S	200	251	205	91

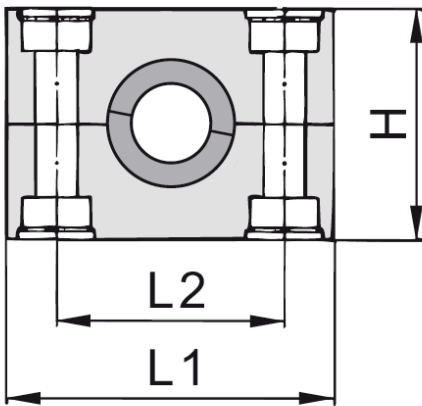

Group	Material	Article
4S	Polypropylene	751855
5S	Polypropylene	927422
6S	Polypropylene	927430
7S	Polypropylene	964697
8S	Polypropylene	11356939
9S	Polypropylene	11358087

Disclaimer: The content of this document has been composed with the utmost care. However, it is possible that certain information changes over time, becomes inaccurate or incomplete. ERIKS does not guarantee that the information provided on this document is up to date, accurate and complete; the information provided is not intended to be advice. ERIKS shall never be liable for damage resulting from the use of the information provided.