

DIN125A Flat washer Steel zinc plated

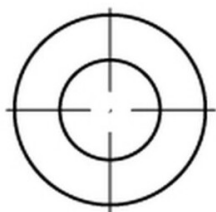

Characteristics

Series: DIN 125A

Material: Carbon steel

Surface protection: Galvanic/electrolytic zinc plated

DIN standard: 125A

Facet: No

ISO standard: 7089



Inner diameter	Outer diameter	Thickness	Suitable for bolt size metric (M..)	Article
mm	mm	mm		
2.2	5	0.3	2	23689036
2.7	6	0.5	2.5	11760638
2.7	6	0.5	2.5	11760643
2.7	6	0.5	2.5	23689037
3.2	7	0.5	3	23256087
3.2	7	0.5	3	11760645
4.3	9	0.8	4	23689039
4.3	9	0.8	4	12692513
4.3	9	0.8	4	23256088
5.3	10	1	5	11760648
5.3	10	1	5	23256089
6.4	12	1.6	6	23256090
6.4	12	1.6	6	11760649
6.4	12	1.6	6	12692514
8.4	16	1.6	8	23256093
8.4	16	1.6	8	23689043
8.4	16	1.6	8	12692506
10.5	20	2	10	23689044
10.5	20	2	10	23256094
12	24	2.5	11	23256095
13	24	2.5	12	23256096
13	24	2.5	12	23256124
13	24	2.5	12	23689045
13	24	2.5	12	12692508
15	28	2.5	14	12692509
15	28	2.5	14	23256097
17	30	3	16	23256098
17	30	3	16	12692510
19	34	3	18	23256099
21	37	3	20	23256100
21	37	3	20	11760657
21	37	3	20	12692512

Disclaimer: The content of this document has been composed with the utmost care. However, it is possible that certain information changes over time, becomes inaccurate or incomplete. ERIKS does not guarantee that the information provided on this document is up to date, accurate and complete; the information provided is not intended to be advice. ERIKS shall never be liable for damage resulting from the use of the information provided.

Inner diameter	Outer diameter	Thickness	Suitable for bolt size metric (M..)	Article
mm	mm	mm		
23	39	3	22	23256101
28	50	4	27	23256103
31	56	4	30	23256104
34	60	5	33	23256105
37	66	5	36	23256106
46	85	7	45	23256109

Disclaimer: The content of this document has been composed with the utmost care. However, it is possible that certain information changes over time, becomes inaccurate or incomplete. ERIKS does not guarantee that the information provided on this document is up to date, accurate and complete; the information provided is not intended to be advice. ERIKS shall never be liable for damage resulting from the use of the information provided.