

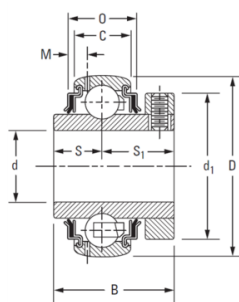

TIMKEN Wide inner ring insert bearing Spherical Outer Ring Concentric Locking Collar Series: GC..KRRB

- Wide inner-ring ball bearing. Industrial series GC-KRRB concentric collar
Relubricatable types These bearing are relubricatable with spherical outside diameters and shroud seals.
- The metal shroud maintains tight seal contact against the inner ring and shields the rubber seals from damage because of dirt or fiber wrap.
- The concentric collar is locked to the shaft by two set screws located 120 degrees apart, mated with threaded holes in the collar and drilled holes in the bearing inner ring.
- The extra-wide design provides additional shaft support and extralarge grease capacity.



Characteristics

Series: GC..KRRB

Model: Spherical Outer Ring

Shaft Locking Type: Concentric Locking Collar

With sealing: Yes

| Manufacturer ID | Shaft diameter | | Outer diameter | | Article |
|-------------------|----------------|-----|----------------|----|----------|
| | in | mm | mm | mm | |
| GC1012KRRB + COL | 3/4 | 40 | 26.59 | 12 | 13163452 |
| GC1100KRRB + COL | 1 | 52 | 34.13 | 15 | 13163451 |
| GC1102KRRB + COL | 1.1/8 | 62 | 67.31 | 18 | 13163450 |
| GC1103KRRB + COL | 1.3/16 | 62 | 67.31 | 18 | 13163449 |
| GC1103KRRB3 + COL | 1.3/16 | 62 | 67.31 | 18 | 13163448 |
| GC1104KRRB + COL | 1.1/4 | 72 | 41.28 | 19 | 13163447 |
| GC1106KRRB + COL | 1.3/8 | 72 | 41.28 | 19 | 13163446 |
| GC1108KRRB + COL | 1.1/2 | 80 | 44.05 | 21 | 13163444 |
| GC1112KRRB + COL | 1.3/4 | 85 | 46.83 | 22 | 13163442 |
| GC1107KRRB + COL | 1.7/16 | 72 | 41.28 | 19 | 13163445 |
| GC1111KRRB + COL | 1.11/16 | 85 | 46.83 | 22 | 13163443 |
| GC1115KRRB + COL | 1.15/16 | 90 | 48.42 | 23 | 13163441 |
| GC1200KRRB + COL | 2 | 100 | 53.97 | 24 | 13163439 |
| GC1203KRRB + COL | 2.3/16 | 100 | 53.97 | 24 | 13163438 |
| GC1207KRRB + COL | 2.7/16 | 110 | 60.32 | 27 | 13163437 |

Disclaimer: The content of this document has been composed with the utmost care. However, it is possible that certain information changes over time, becomes inaccurate or incomplete. ERIKS does not guarantee that the information provided on this document is up to date, accurate and complete; the information provided is not intended to be advice. ERIKS shall never be liable for damage resulting from the use of the information provided.