

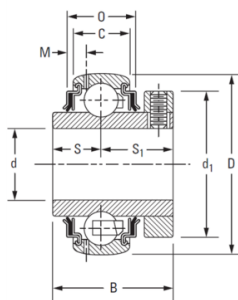

TIMKEN Wide inner ring insert bearing Spherical Outer Ring Concentric Locking Collar Series: GC..KRRB

- Wide inner-ring ball bearing. Industrial series GC-KRRB concentric collar
Relubricatable types These bearing are relubricatable with spherical outside diameters and shroud seals.
- The metal shroud maintains tight seal contact against the inner ring and shields the rubber seals from damage because of dirt or fiber wrap.
- The concentric collar is locked to the shaft by two set screws located 120 degrees apart, mated with threaded holes in the collar and drilled holes in the bearing inner ring.
- The extra-wide design provides additional shaft support and extralarge grease capacity.



Characteristics

Series: GC..KRRB

Model: Spherical Outer Ring

Shaft Locking Type: Concentric Locking Collar

With sealing: Yes

Manufacturer ID	Shaft diameter		Outer diameter		Article
	in	mm	mm	mm	
GC1012KRRB + COL	3/4	40	26.59	12	13163452
GC1100KRRB + COL	1	52	34.13	15	13163451
GC1102KRRB + COL	1.1/8	62	67.31	18	13163450
GC1103KRRB + COL	1.3/16	62	67.31	18	13163449
GC1103KRRB3 + COL	1.3/16	62	67.31	18	13163448
GC1104KRRB + COL	1.1/4	72	41.28	19	13163447
GC1106KRRB + COL	1.3/8	72	41.28	19	13163446
GC1108KRRB + COL	1.1/2	80	44.05	21	13163444
GC1112KRRB + COL	1.3/4	85	46.83	22	13163442
GC1107KRRB + COL	1.7/16	72	41.28	19	13163445
GC1111KRRB + COL	1.11/16	85	46.83	22	13163443
GC1115KRRB + COL	1.15/16	90	48.42	23	13163441
GC1200KRRB + COL	2	100	53.97	24	13163439
GC1203KRRB + COL	2.3/16	100	53.97	24	13163438
GC1207KRRB + COL	2.7/16	110	60.32	27	13163437

Disclaimer: The content of this document has been composed with the utmost care. However, it is possible that certain information changes over time, becomes inaccurate or incomplete. ERIKS does not guarantee that the information provided on this document is up to date, accurate and complete; the information provided is not intended to be advice. ERIKS shall never be liable for damage resulting from the use of the information provided.