

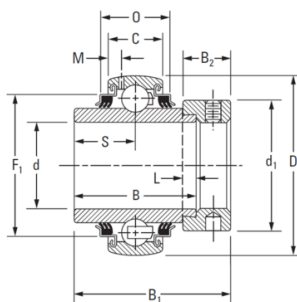

TIMKEN Wide inner ring insert bearing Spherical Outer Ring Eccentric Locking Collar Series: G..KPPB

- Wide inner-ring ball bearing. Industrial series TRI-PLY seal
Non-relubricatable and relubricatable types Tri-ply seal bearings are dimensionally interchangeable with KRRB bearings and can be used with standard housings.
- One-piece tri-ply seals incorporate a highly effective seal design molded to an exterior shroud cap. The shroud cap protects the seal lip from fiber wrap and abrasion.
- Supplied with a self-locking collar, the bearings are most effective in environments with severe contamination and moisture.
- Relubricatable tri-ply seal bearings are dimensionally interchangeable with G-KRRB bearings.
- This design can be used with standard housings.



Characteristics

Series: G..KPPB

Model: Spherical Outer Ring

Shaft Locking Type: Eccentric Locking Collar

With sealing: Yes

Manufacturer ID	Shaft diameter mm	Shaft diameter in	Outer diameter mm	Outer ring width mm	Article
G1100KPPB3 + COL		1	52	15	24021189
G1102KPPB3 + COL		1.1/8	62	18	13163485
G1103KPPB3 + COL		1.3/16	62	18	13163482
G1103KPPB4 + COL		1.3/16	62	18	24021194
G1104KPPB2 + COL		1.1/4	72	19	13163478
G1106KPPB2 + COL		1.3/8	72	19	13163476
G1108KPPB3 + COL		1.1/2	80	21	24021208
G1112KPPB4 + COL		1.3/4	85	22	24021215
G1107KPPB2 + COL		1.7/16	72	19	13163473
G1111KPPB4 + COL		1.11/16	85	22	13163469
G1115KPPB3 + COL		1.15/16	90	23	13163464
G1200KPPB4 + COL		2	100	24	13163462
G1203KPPB4 + COL		2.3/16	100	24	24021222
GE25KPPB3 + COL	25		52	15	13163436
GE30KPPB3 + COL	30		62	18	13163435

Disclaimer: The content of this document has been composed with the utmost care. However, it is possible that certain information changes over time, becomes inaccurate or incomplete. ERIKS does not guarantee that the information provided on this document is up to date, accurate and complete; the information provided is not intended to be advice. ERIKS shall never be liable for damage resulting from the use of the information provided.