



ASCO Pilot valve 3/2 fig. 33007 series 314/356 brass

Characteristics

Series: 356C
Type: 33007
Model: Pilot valve 3/2 way
Process connection: External thread (BSPP)
Function: Universal
Actuation: Direct-acting
Including plug: Yes
Minimum pressure difference: 0 bar
Housing material: Brass
Working time: 100 %

Characteristics [2]

Emergency manual operation: Yes
Explosion-proof: No
SIL certified: No
Medium temperature: From -10 °C to 60 °C
Ambient temperature: From -10 °C to 60 °C

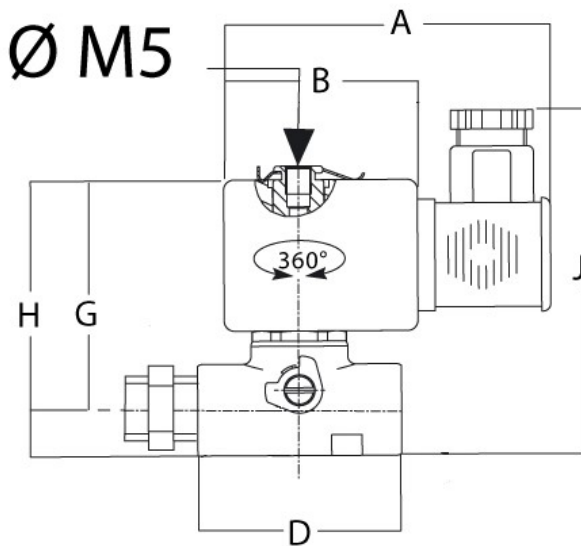

Size table:

Connection	A	B	D	G	H	J	Weight
	mm	mm	mm	mm	mm	mm	kg
1/4"	95	57	40		82	96	0.6
1/8"	62	30	33	45	52	70	

Size process connection	Air supply connection	Size of air supply connection	Connection air exhaust(s)	Coil type	Supply voltage	Frequency	Electrical connection	Power	Starting power	Article
1/4" [8]	Internal thread (BSPP)	1/4" [8]	1/8" [6]	SPC	24V DC		Plug EN 175301-803 type A	8.5 W [hot] - 11.6 W [cold]		12588689
1/4" [8]	Internal thread (BSPP)	1/4" [8]	1/8" [6]	SPC	230V AC	50Hz	Plug EN 175301-803 type A	10.1 W / 25 VA	50 VA	12588690
1/8" [6]			M5	400127-181	24V AC	50Hz	Plug EN 175301-803 type B	4 W / 6 VA	12 VA	11489205
1/8" [6]			M5	400127-197	230V AC	50Hz	Plug EN 175301-803 type B	4 W / 6 VA	12 VA	11481475
1/8" [6]	Internal thread (BSPP)	1/8" [6]	M5	SPC	24V AC	50/60Hz	Plug EN 175301-803 type B	3 W / 4.5 VA		14518830
1/8" [6]	Internal thread (BSPP)	1/8" [6]	M5	SPC	24V DC		Plug EN 175301-803 type B	5 W		14518617
1/8" [6]	Internal thread (BSPP)	1/8" [6]	M5	SPC	115V AC	50/60Hz	Plug EN 175301-803 type B	3 W / 4.5 VA		14528522

Disclaimer: The content of this document has been composed with the utmost care. However, it is possible that certain information changes over time, becomes inaccurate or incomplete. ERIKS does not guarantee that the information provided on this document is up to date, accurate and complete; the information provided is not intended to be advice. ERIKS shall never be liable for damage resulting from the use of the information provided.

Size process connection	Air supply connection	Size of air supply connection	Connection air exhaust(s)	Coil type	Supply voltage	Frequency	Electrical connection	Power	Starting power	Article
1/8" [6]	Internal thread (BSPP)	1/8" [6]	M5	SPC	230V AC	50/60Hz	Plug EN 175301-803 type B	3 W / 4.5 VA		14518618

Disclaimer: The content of this document has been composed with the utmost care. However, it is possible that certain information changes over time, becomes inaccurate or incomplete. ERIKS does not guarantee that the information provided on this document is up to date, accurate and complete; the information provided is not intended to be advice. ERIKS shall never be liable for damage resulting from the use of the information provided.