



VAG Butterfly valve Series: EKN® M Type: 21177 Ductile cast iron/Ductile cast iron Double-eccKIWA Gearbox Flange



Characteristics

- Series:** EKN® M
- Type:** 21177
- Norm:** EN (DIN)
- Valve design:** Double-eccentric
- Housing material:** Ductile cast iron
- Material quality:** EN-JS1030
- Surface protection:** Epoxy coating (in- and external)
- Connection:** Flange

Characteristics [2]

- Face to Face norm:** EN 558, Series 14
- Operation:** Gearbox
- Disk material:** Ductile cast iron
- Quality class disc:** EN-JS1030
- Actuator material:** EN-JL1040
- KIWA:** Yes

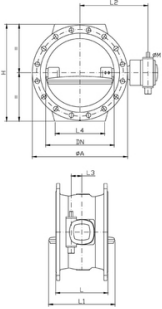

Nominal inner diameter	Pressure rating	Face to Face length	Material liner	Spindle material	Quality class spindle	Minimum medium temperature (continuous)	Maximum medium temperature (continuous)	Article
						°C	°C	
DN400	PN10	310	EPDM-KIWA	Stainless steel	1.4021	0	30	12674214
DN500	PN10	350	EPDM-KIWA	Stainless steel	1.4021	0	30	12674215
DN600	PN10	390	EPDM-KIWA	Stainless steel	1.4021	0	30	12674216
DN800	PN10	470	EPDM-KIWA	Stainless steel	1.4021	0	30	12674218

Disclaimer: The content of this document has been composed with the utmost care. However, it is possible that certain information changes over time, becomes inaccurate or incomplete. ERIKS does not guarantee that the information provided on this document is up to date, accurate and complete; the information provided is not intended to be advice. ERIKS shall never be liable for damage resulting from the use of the information provided.