

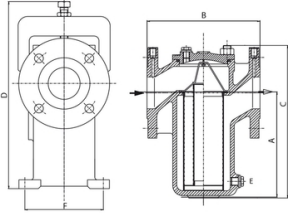

## ECON® Single filter Type: 1096 Ductile cast iron EN-JS1050 Flange

### Characteristics

- Type:** 1096
- Norm:** EN (DIN)
- Housing material:** Ductile cast iron
- Material quality:** EN-JS1050
- Surface protection:** Epoxy coating (external)
- Connection:** Flange
- Venting screw:** Yes
- Drain connection:** Yes
- Material cover gasket:** NBR
- Material drain plug:** Stainless steel
- Material vent screw:** Stainless steel



### Application

- Water, oil and other process fluids
- Horizontal piping
- Suitable for pressure pipes

### Technical Information

- Supplied without screen as standard
- Fitted with drain plug
- Max. differential pressure 1bar

### Options

- Can be supplied with clip lock
- Available with perforations of 20 microns or higher

Nominal inner diameter	Pressure rating	Face to Face length mm	With filter element	Flow direction	Article
DN15	PN16	171	No	Horizontal	13289652
DN20	PN16	171	No	Horizontal	13289653
DN25	PN16	171	No	Horizontal	13289654
DN32	PN16	189	No	Horizontal	13289655
DN40	PN16	189	No	Horizontal	13289656
DN50	PN16	189	No	Horizontal	13289657
DN80	PN16	279	No	Horizontal	13289659
DN100	PN16	317	No	Horizontal	13289660
DN125	PN10	379	No	Horizontal	13289648
DN150	PN10	461	No	Horizontal	13289649
DN250	PN10	604	No	Horizontal	13289651

Disclaimer: The content of this document has been composed with the utmost care. However, it is possible that certain information changes over time, becomes inaccurate or incomplete. ERIKS does not guarantee that the information provided on this document is up to date, accurate and complete; the information provided is not intended to be advice. ERIKS shall never be liable for damage resulting from the use of the information provided.