



## GUTH VENTILE Butterfly Valve Series: 4351 Stainless steel AISI 316L/EPDM Lever Butt weld Inch dimensions

### Characteristics

- Series:** 4351
- Valve design:** Centric
- Housing material:** Stainless steel
- Abbreviation name of material:** AISI 316L
- Material quality:** 1.4404
- Internal roughness value:** Ra ≤ 0.8 µm electro polished
- Connection:** Butt weld
- Operation:** Handle
- Housing lining:** Replaceable
- Disk material:** AISI 316L
- Quality class disc:** 1.4404
- Ambient temperature:** 4 / 45 °C

### Application

- Food products.
- Dairy.
- Milk.
- Beer.
- CIP.
- Fruit juice.
- Water.
- Sauces.
- Oils.
- Recommended in: Food & Beverages, Food primary processes [contact with food]

### Technical Information

- Operation open/closed.
- Sterilisation temperature 140 °C [SIP 30 min.].

### Construction

- Two-piece body and one-piece valve/spindle.
- Centric valve design.
- Equipped with bearing bushings.

### Approval

- EC1935/2004 certification towards the seat.
- FDA admission towards the seat.

### Options

- Pneumatic actuation.
- Extended control and signalling capabilities.
- Construction in stainless steel AISI 304L [1.4307].
- Sealing in silicone, HNBR or FPM.
- Connection with Tri-clamp according to DIN 32676.
- Weld connection according to EN10357 Series A [DIN 11850 Series 2].
- Threaded connection according to DIN 11851 or DIN 11864.
- Three-way design through T-piece connection.
- 3.1 Certificate.

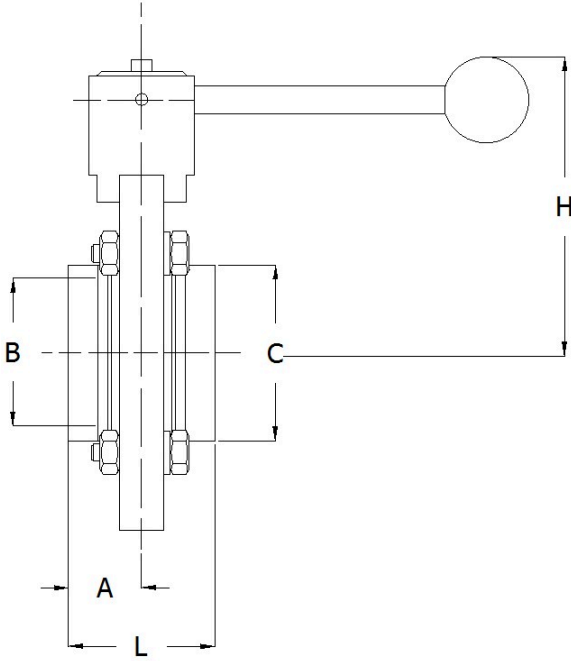

Size table:

DN	A mm	B mm	C mm	H mm	L mm	Weight kg
3"	50	72.9	76.1	118	100	3.22
4"	52	97.4	101.6	132	104	3.95
1"	32	22.1	25.4	88	64	1.34
1.1/2"	36	34.8	38.1	94	72	1.52
2"	36	47.5	50.8	101	72	1.8
2.1/2"	38	60.2	63.5	110	76	2.25

Nominal inner diameter	External tube diameter of connection	Wall thickness, connection	Pressure rating	Face to Face length	Material liner	Minimum medium temperature (continuous)	Maximum medium temperature (continuous)	Maximum pressure difference as end valve	Article
	mm	mm		mm		°C	°C	bar	
3" (ø 72.1 mm)	76.1	1.6	PN10	100	EPDM	0	95	10	14671848
4" (ø 97.6 mm)	101.6	2.1	PN16	104	EPDM	0	95	10	14671849
1" (ø 22.9 mm)	25.4	1.65	PN16	64	EPDM	0	95	16	14671845
1.1/2" (ø 35.1 mm)	38.1	1.65	PN16	72	EPDM	0	95	16	14671846
2" (ø 47.8 mm)	50.8	1.65	PN16	72	EPDM	0	95	16	14671866
2.1/2" (ø 60.5 mm)	63.5	1.65	PN16	76	EPDM	0	95	16	14671847

Disclaimer: The content of this document has been composed with the utmost care. However, it is possible that certain information changes over time, becomes inaccurate or incomplete. ERIKS does not guarantee that the information provided on this document is up to date, accurate and complete; the information provided is not intended to be advice. ERIKS shall never be liable for damage resulting from the use of the information provided.