



## ADCA Pneumatic actuated control valve Type: 25843: Series: V16/2i Stainless steel internal thread ISO 7/Rp

### Characteristics

**Series:** V16/2i  
**Type:** 25843  
**Function:** Control valve  
**Construction type:** Straight  
**Housing material:** Stainless steel 316L  
**Material quality:** 1.4408  
**Process connection:** Internal thread [BSPP]  
**Standard connection:** ISO 7/1 Rp  
**Ground characteristic:** Equal percentage  
**Plug:** Parabolic cone  
**Control range:** 50:1  
**Leakage class:** IV according IEC 60534-4  
**Stem seal type:** Roof cuffs  
**Material bonnet:** Stainless steel 316 [1.4408]  
**Material cone:** Stainless steel 316L [1.4404]  
**Seat material:** Stainless steel 316L [1.4404]  
**Spindle material:** Stainless steel 316L [1.4404]  
**Primary spindle seal material:** PTFE  
**Bonnet gasket material:** Graphite  
**Type of actuator:** Pneumatic  
**Function actuator:** Spring closing  
**Positioner:** ECON 3301  
**Control signal:** 4 - 20 mA  
**Explosion-proof:** No  
**Level of protection (IP value):** IP66  
**With end contacts:** No  
**Position indicator:** Yes  
**Manual operation:** No  
**Medium temperature:** -10 / 220 °C  
**Ambient temperature:** -30 / 85 °C

### Application

- Water, neutral liquids and gases.
- Steam.
- Thermo oil or volatile gases (with option stainless steel spindle bellows).

### Technical Information

- Compact and modular design.
- Stainless steel internals with bronze valve guide.
- Pneumatic actuator with spring return.
- Econ® Series 3300 digital positioner.

### Approval

#### PED 2014/68/EU fluid group 2

- DN15 - DN50 ; Classification PED-SEP.
- DN65 - DN100 ; Classification PED-Cat.I [CE marking].

### Options

- Stainless steel spindle bellows.
- Various sealing variants.
- Positioners with feedback 4 - 20 mA and HART.
- Body in steel.
- Actuator in stainless steel.
- Electric actuator.

Size table:

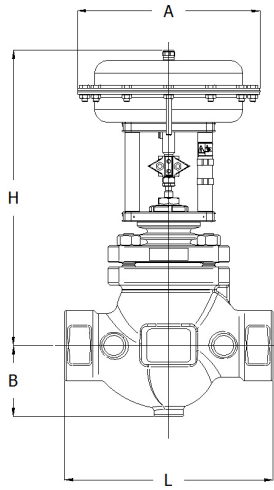

Dimension	Actuator	A	B	H	L	Weight
		mm	mm	mm	mm	kg
1/2"	PA10	170	37.5	354	100	12.6
3/4"	PA10	170	37.5	354	100	12.6
1"	PA10	170	37.5	354	100	12.7
1.1/2"	PA25	250	65	373	190	21.4
2"	PA25	250	81	385	220	23.4

Nominal inner diameter	Size process connection	Pressure rating	Kvs value	Stroke	Type coding actuator	Diaphragm area	Spring range	Closing pressure	With feedback signal	Article
			m <sup>3</sup> /h							
DN15	1/2"	PN40	2.7	20	PA10	100	0.2 - 1.0 bar	16	No	14621053
DN15	1/2"	PN40	4	20	PA10	100	0.2 - 1.0 bar	11.1	No	14621054
DN20	3/4"	PN40	4	20	PA10	100	0.2 - 1.0 bar	11.1	No	14621055
DN20	3/4"	PN40	6.3	20	PA10	100	1.2 - 2.0 bar	16	No	14621056
DN25	1"	PN40	6.3	20	PA10	100	1.2 - 2.0 bar	16	No	14621057
DN25	1"	PN40	10	20	PA10	100	1.2 - 2.0 bar	12.8	No	14621058
DN40	1.1/2"	PN40	16	20	PA25	250	0.4 - 2.0 bar	16	No	14621059
DN40	1.1/2"	PN40	25	20	PA25	250	1.0 - 2.0 bar	15.5	No	14621060
DN50	2"	PN40	25	20	PA25	250	1.0 - 2.0 bar	15.5	No	14621061
DN50	2"	PN40	40	20	PA25	250	2.0 - 4.0 bar	16	No	14621062

Disclaimer: The content of this document has been composed with the utmost care. However, it is possible that certain information changes over time, becomes inaccurate or incomplete. ERIKS does not guarantee that the information provided on this document is up to date, accurate and complete; the information provided is not intended to be advice. ERIKS shall never be liable for damage resulting from the use of the information provided.