

## GUTH VENTILE Butterfly valve Series: 4303 Stainless steel AISI 304L/EPDM Lever External thread DIN 11851



### Characteristics

**Series:** 4303  
**Norm:** EN (DIN)  
**Valve design:** Centric  
**Housing material:** Stainless steel  
**Abbreviation name of material:** AISI 304L  
**Material quality:** 1.4307  
**Internal roughness value:** Ra ≤ 0.8 µm electro polished  
**Connection:** External thread DIN 11851  
**Operation:** Handle  
**Housing lining:** Replaceable  
**Disk material:** AISI 304L  
**Quality class disc:** 1.4307  
**Primary spindle seal material:** EPDM  
**Ambient temperature:** 4 / 45 °C

### Application

- Food products.
- Dairy.
- Milk.
- Beer.
- CIP.
- Fruit juice.
- Water.
- Sauces.
- Oils.
- Recommended in: Food & Beverages, Food primary processes [contact with food]

### Technical Information

- Operation open/closed.
- Sterilisation temperature 140 °C (SIP 30 min.).

### Construction

- Two-piece body and one-piece valve/spindle.
- Centric valve design.
- Equipped with bearing bushings.

### Approval

- EC1935/2004 certification towards the seat.
- FDA admission towards the seat.

### Options

- Pneumatic actuation.
- Extended control and signalling capabilities.
- Construction in stainless steel AISI 316L [1.4404].
- Sealing in silicone, HNBR or FPM.
- Connection with Tri-clamp according to DIN 32676.
- Weld connection according to EN10357 Series A [DIN 11850 Series 2].
- Threaded connection according to DIN 11864.
- Three-way design through T-piece connection.
- 3.1 Certificate.

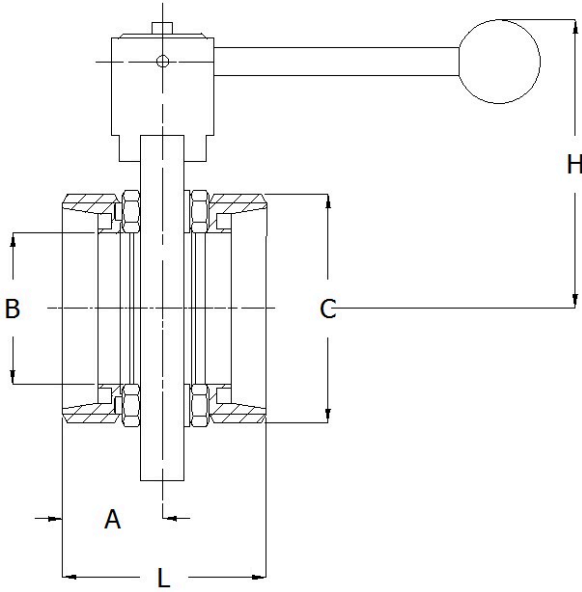

Size table:

DN	A mm	B mm	C mm	H mm	L mm	Weight kg
DN80	50	81	110	122	100	4.02
DN100	52	100	130	134	104	5.1
DN25	32	26	52	88	64	1.48
DN32	32	32	58	88	64	1.61
DN40	36	38	65	94	72	1.85
DN50	36	50	78	101	72	2.24
DN65	38	66	95	110	76	2.82

Nominal inner diameter	Size of dairy thread connection (DIN 405) DN	Pressure rating	Face to Face length mm	Material liner	Seat material	PMO - maximum operating pressure bar	Minimum medium temperature (continuous) °C	Maximum medium temperature (continuous) °C	Maximum pressure difference as end valve bar	Article
DN80	Rd 110 x 1/4"	PN10	100	EPDM	AISI 304L	10	0	95	10	14671858
DN100	Rd 130 x 1/4"	PN10	104	EPDM	AISI 304L	10	0	95	10	14671789
DN25	Rd 52 x 1/6"	PN16	64	EPDM	AISI 304L	16	0	95	16	14671856
DN32	Rd 58 x 1/6"	PN16	64	EPDM	AISI 304L	16	0	95	16	14671786
DN40	Rd 65 x 1/6"	PN16	72	EPDM	AISI 304L	16	0	95	16	14671857
DN50	Rd 78 x 1/6"	PN16	72	EPDM	AISI 304L	16	0	95	16	14671787
DN65	Rd 95 x 1/6"	PN16	76	EPDM	AISI 304L	16	0	95	16	14671788

Disclaimer: The content of this document has been composed with the utmost care. However, it is possible that certain information changes over time, becomes inaccurate or incomplete. ERIKS does not guarantee that the information provided on this document is up to date, accurate and complete; the information provided is not intended to be advice. ERIKS shall never be liable for damage resulting from the use of the information provided.