

## STAUFF Weld plate type SP Standard series ACT

### Characteristics

**Series:** Standard

**Type:** SP

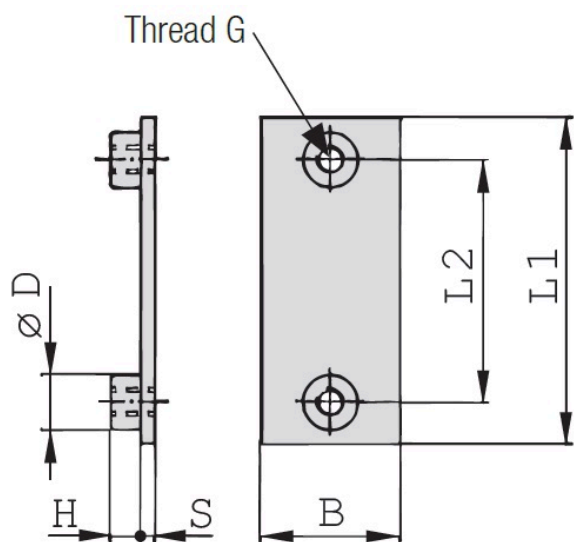

Size table:

Group	B mm	G	H mm	L1 mm	L2 mm	ØD mm	S mm
1A	30	M 6	6.5	36	20	12	3
2	30	M 6	6.5	42	26	12	3
3	30	M 6	6.5	50	33	12	3

Group	Material	Surface protection	Article
1A	Stainless steel 316 (V4A)	ACT	12529197
2	Stainless steel 316 (V4A)	ACT	12529198
3	Stainless steel 316 (V4A)	ACT	12529199

Disclaimer: The content of this document has been composed with the utmost care. However, it is possible that certain information changes over time, becomes inaccurate or incomplete. ERIKS does not guarantee that the information provided on this document is up to date, accurate and complete; the information provided is not intended to be advice. ERIKS shall never be liable for damage resulting from the use of the information provided.