

ECON® Pressure spring thermometer fig. 3533 stainless steel distance capillary bottom wall flange



Characteristics

Accuracy class: 1.0 %
Capillar location: Below
Mounting method: Wall flange
Cabinet diameter: 100 mm
Length of capillary: 2000 mm
Process connection: External thread (BSPP)
Size process connection: 1/2" (15)
Process connection material: Stainless steel 304
Cabinet material: Stainless steel 304
Window material: Glass

Characteristics (2)

Material dial: Aluminium
Material mechanism: Brass
Capillary material: Stainless steel
Material sensor: Stainless steel 321 (1.4541)
Pocket tube material: Stainless steel 321 (1.4541)
Level of protection (IP value): IP65

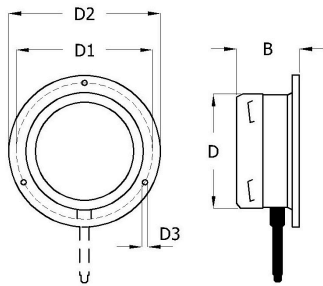

Size table:

Sensor type	Insert length mm	G	B mm	C mm	D mm	D1 mm	D2 mm	D3 mm	d mm
H	100	1/2"	51	50	101	116	132	5.5	10
H	160	1/2"	51	50	101	116	132	5.5	10
A10A	100	1/2"	51		101	116	132	5.5	125
A10A	160	1/2"	51		101	116	132	5.5	125

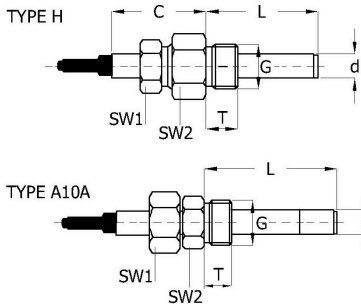

Overview of optional probe types and process connections according to DIN16189

Sensor type	Description of the sensor and connection
G	Plain stem sensor AISI321.
A	Coupling nut AISI304, sensor AISI321.
A10A	Coupling nut and pocket tube with male threading.
J	Fixed nipple (external thread), sensor AISI321.
L	Turning nipple (external thread), sensor AISI321.
H	Adjustable connection sliding on stem, sensor AISI321.
B	Coupling nut and double nipple AISI304, sensor AISI321..
N	Tri-clamp ISO2852, BS4825 and DIN32676, sizes 1" - 1.1/2" - 2", AISI316, sensor AISI321 polished.

Disclaimer: The content of this document has been composed with the utmost care. However, it is possible that certain information changes over time, becomes inaccurate or incomplete. ERIKS does not guarantee that the information provided on this document is up to date, accurate and complete; the information provided is not intended to be advice. ERIKS shall never be liable for damage resulting from the use of the information provided.

Overview of optional probe types and process connections according to DIN16189

Sensor type

Description of the sensor and connection

P

Sanitary coupling, nipple, coupling nut DIN11851, sizes DN25 through DN80, AISI316, sensor AISI321 polished.

Measuring range °C	Sensor type	With pocket tube	Insert length mm	Sensor diameter mm	Article
0 / 100	H	No	100	10	14422334
0 / 100	H	No	160	10	14422337
0 / 100	A10A	Yes	100	12.5	14422328
0 / 100	A10A	Yes	160	12.5	14422331
0 / 120	H	No	100	10	14422335
0 / 120	H	No	160	10	14422338
0 / 120	A10A	Yes	100	12.5	14422329
0 / 120	A10A	Yes	160	12.5	14422332
0 / 160	H	No	100	10	14422336
0 / 160	H	No	160	10	14422339
0 / 160	A10A	Yes	160	12.5	14422333
0 / 160	A10A	Yes	100	12.5	14422330

Disclaimer: The content of this document has been composed with the utmost care. However, it is possible that certain information changes over time, becomes inaccurate or incomplete. ERIKS does not guarantee that the information provided on this document is up to date, accurate and complete; the information provided is not intended to be advice. ERIKS shall never be liable for damage resulting from the use of the information provided.