

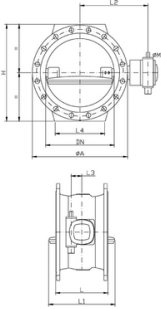

VAG Butterfly valve Series: EKN® M Type: 21177 Ductile cast iron/Ductile cast iron Double-eckKIWA Gearbox Flange



Characteristics

Series: EKN® H
Type: 21177
Norm: EN (DIN)
Valve design: Double-eccentric
Housing material: Ductile cast iron
Material quality: EN-JS1030
Surface protection: Epoxy coating (in- and external)
Connection: Flange

Characteristics [2]

Face to Face norm: EN 558, Series 14
Operation: Gearbox
Disk material: Ductile cast iron
Quality class disc: EN-JS1030
Actuator material: EN-JL1040
KIWA: Yes

Nominal inner diameter	Pressure rating	Face to Face length	Material liner	Spindle material	Quality class spindle	Minimum medium temperature (continuous)	Maximum medium temperature (continuous)	Article
		mm				°C	°C	
DN150	PN16	210	EPDM-KIWA	Stainless steel	1.4021	0	30	14337545
DN200	PN10	230	EPDM-KIWA	Stainless steel	1.4021	0	30	14337546
DN200	PN16	230	EPDM-KIWA	Stainless steel	1.4021	0	30	14337547
DN250	PN10	250	EPDM-KIWA	Stainless steel	1.4021	0	30	14337548
DN250	PN16	250	EPDM-KIWA	Stainless steel	1.4021	0	30	14337549
DN300	PN10	270	EPDM-KIWA	Stainless steel	1.4021	0	30	14337550
DN300	PN16	270	EPDM-KIWA	Stainless steel	1.4021	0	30	14337551
DN350	PN10	290	EPDM-KIWA	Stainless steel	1.4021	0	30	14337552
DN350	PN16	290	EPDM-KIWA	Stainless steel	1.4021	0	30	14337553
DN400	PN10	310	EPDM-KIWA	Stainless steel	1.4021	0	30	14337554
DN400	PN16	310	EPDM-KIWA	Stainless steel	1.4021	0	30	14337555
DN450	PN10	330	EPDM-KIWA	Stainless steel	1.4021	0	30	14337556
DN450	PN16	330	EPDM-KIWA	Stainless steel	1.4021	0	30	14337557
DN500	PN10	350	EPDM-KIWA	Stainless steel	1.4021	0	30	14337558
DN500	PN16	350	EPDM-KIWA	Stainless steel	1.4021	0	30	14337559
DN600	PN10	390	EPDM-KIWA	Stainless steel	1.4021	0	30	14337560
DN600	PN16	390	EPDM-KIWA	Stainless steel	1.4021	0	30	14337561
DN700	PN10	430	EPDM-KIWA	Stainless steel	1.4021	0	30	14337562
DN700	PN16	430	EPDM-KIWA	Stainless steel	1.4021	0	30	14337563
DN800	PN10	470	EPDM-KIWA	Stainless steel	1.4021	0	30	14337564
DN800	PN16	470	EPDM-KIWA	Stainless steel	1.4021	0	30	14337565
DN900	PN10	510	EPDM-KIWA	Stainless steel	1.4021	0	30	14337566
DN900	PN16	510	EPDM-KIWA	Stainless steel	1.4021	0	30	14337567
DN1000	PN10	550	EPDM-KIWA	Stainless steel	1.4021	0	30	14337568
DN1000	PN16	550	EPDM-KIWA	Stainless steel	1.4021	0	30	14337569
DN1100	PN10	590	EPDM-KIWA	Stainless steel	1.4021	0	30	14337570
DN1100	PN16	590	EPDM-KIWA	Stainless steel	1.4021	0	30	14337571
DN1200	PN10	630	EPDM-KIWA	Stainless steel	1.4021	0	30	14337572
DN1200	PN16	630	EPDM-KIWA	Stainless steel	1.4021	0	30	14337573

Disclaimer: The content of this document has been composed with the utmost care. However, it is possible that certain information changes over time, becomes inaccurate or incomplete. ERIKS does not guarantee that the information provided on this document is up to date, accurate and complete; the information provided is not intended to be advice. ERIKS shall never be liable for damage resulting from the use of the information provided.