



GRUNDFOS Inline circulator pump series MAGNA1 stainless steel iron flange

The MAGNA1 is a cost-effective and high-performance circulation pump. The pump, equipped with parts being only of important relevance to the performance of its core task, requires little maintenance and has a long service life.

- Easy installation
- Low energy consumption. MAGNA1 pumps meet the requirements of EuP 2013 and 2015
- Nine possible pump settings
- Low noise level.
- Minimal maintenance and a long service life.
- Product range also available for a maximum system pressure of 16 bar.

Characteristics

Series: MAGNA1

Connection: Flange

Material pump casing: Stainless steel

Material quality: 1.4308

Impeller material: Composite material

Quality class of impeller material: PES 30% GF

Frequency: 50Hz

Energy efficiency class: IE5

With rotational speed/frequency control: No

Level of protection (IP value): IPX4D [EN 60529]

Insulation class acc. to IEC: F

Double pump: No

Medium temperature: -10 / 110 °C

Ambient temperature: 0 / 40 °C

Application

- Designed for circulating liquids in: Heating systems.
- Air-conditioning and cooling systems.
- Domestic hot-water systems.
- Ground source heat-pump systems.
- Solar-heating systems.

Technical Information

Curve option and control modes:

- Proportional pressure.
- Constant pressure.
- Fixed pump speeds.

•

System pressure:

- The actual inlet pressure and the pump pressure against a closed valve must be less than the maximum permissible system pressure.

Maximum system pressure:

- Is to be found on the pump nameplate.

Sound pressure level:

- Less than 43 dB(A).

Size table:

Model	L1 mm	H1 mm	H2 mm	H3 mm	D1 mm	D4 mm
MAGNA1 32-40	220	65	142	207	32	140
MAGNA1 32-80	220	65	142	207	32	140
MAGNA1 32-60	220	65	142	207	32	140
MAGNA1 32-100	220	65	142	207	32	140
MAGNA1 32-120	220	65	301	366	32	140
MAGNA1 40-40	220	65	156	221	40	150
MAGNA1 40-60	220	65	156	221	40	150
MAGNA1 40-100	220	65	304	369	40	150
MAGNA1 40-80	220	65	304	369	40	150
MAGNA1 40-150	220	65	304	369	40	150
MAGNA1 40-180	220	65	304	369	40	150
MAGNA1 40-120	220	65	304	369	40	150
MAGNA1 50-60	240	71	304	374	50	165
MAGNA1 50-80	240	71	304	374	50	165
MAGNA1 50-150	280	71	304	374	50	165
MAGNA1 50-120	280	71	304	374	50	165
MAGNA1 50-100	280	71	304	374	50	165
MAGNA1 50-180	280	71	304	374	50	165
MAGNA1 65-40	340	74	312	386	65	185
MAGNA1 65-150	340	74	312	386	65	185
MAGNA1 65-80	340	74	312	386	80	185
MAGNA1 65-60	340	74	312	386	65	185
MAGNA1 65-120	340	74	312	386	65	185
MAGNA1 65-100	340	74	312	386	65	185

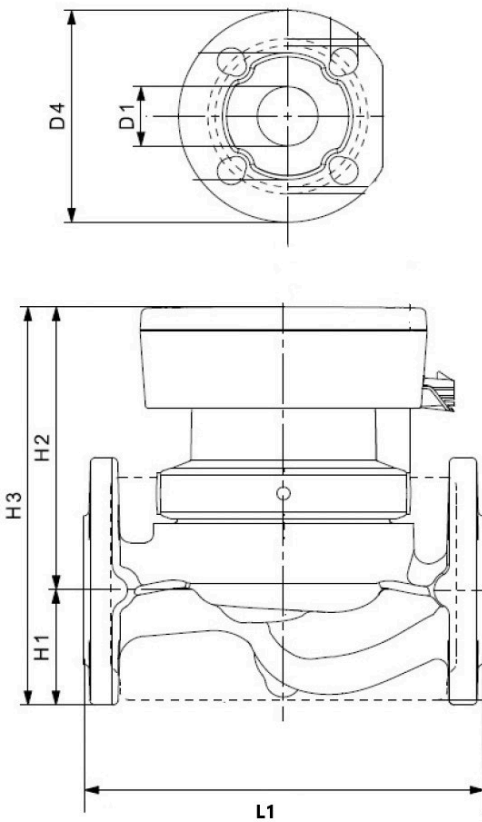

Disclaimer: The content of this document has been composed with the utmost care. However, it is possible that certain information changes over time, becomes inaccurate or incomplete. ERIKS does not guarantee that the information provided on this document is up to date, accurate and complete; the information provided is not intended to be advice. ERIKS shall never be liable for damage resulting from the use of the information provided.

Model	Nominal inner diameter	Max. discharge head m	Pressure rating	Electrical connection	Connection voltage	Article
MAGNA1 32-40	DN32	4	PN6/10	Plug	1 x 230V AC	13643131
MAGNA1 32-80	DN32	8	PN6/10	Plug	1 x 230V AC	13643139
MAGNA1 32-60	DN32	6	PN6/10	Plug	1 x 230V AC	13643135
MAGNA1 32-100	DN32	10	PN6/10	Plug	1 x 230V AC	13643122
MAGNA1 32-120	DN32	12	PN6/10	Connection terminal	1 x 230V AC	13643127
MAGNA1 40-40	DN40	4	PN6/10	Plug	1 x 230V AC	13643152
MAGNA1 40-60	DN40	6	PN6/10	Plug	1 x 230V AC	13643154
MAGNA1 40-100	DN40	10	PN6/10	Connection terminal	1 x 230V AC	13643142
MAGNA1 40-80	DN40	8	PN6/10	Connection terminal	1 x 230V AC	13643157
MAGNA1 40-150	DN40	15	PN6/10	Connection terminal	1 x 230V AC	13643147
MAGNA1 40-180	DN40	18	PN6/10	Connection terminal	1 x 230V AC	13643150
MAGNA1 40-120	DN40	12	PN6/10	Connection terminal	1 x 230V AC	13643145
MAGNA1 50-60	DN50	6	PN6/10	Connection terminal	1 x 230V AC	13643170
MAGNA1 50-80	DN50	8	PN6/10	Connection terminal	1 x 230V AC	13643173
MAGNA1 50-150	DN50	15	PN6/10	Connection terminal	1 x 230V AC	13643165
MAGNA1 50-120	DN50	12	PN6/10	Connection terminal	1 x 230V AC	13643162
MAGNA1 50-100	DN50	10	PN6/10	Connection terminal	1 x 230V AC	13643160
MAGNA1 50-180	DN50	18	PN6/10	Connection terminal	1 x 230V AC	13643168
MAGNA1 65-40	DN65	4	PN6/10	Connection terminal	1 x 230V AC	13643184
MAGNA1 65-150	DN65	15	PN6/10	Connection terminal	1 x 230V AC	13643182
MAGNA1 65-80	DN65	8	PN6/10	Connection terminal	1 x 230V AC	13643190
MAGNA1 65-60	DN65	6	PN6/10	Connection terminal	1 x 230V AC	13643187
MAGNA1 65-120	DN65	12	PN6/10	Connection terminal	1 x 230V AC	13643179
MAGNA1 65-100	DN65	10	PN6/10	Connection terminal	1 x 230V AC	13643176

Disclaimer: The content of this document has been composed with the utmost care. However, it is possible that certain information changes over time, becomes inaccurate or incomplete. ERIKS does not guarantee that the information provided on this document is up to date, accurate and complete; the information provided is not intended to be advice. ERIKS shall never be liable for damage resulting from the use of the information provided.