

GF Ball valve Series: 546 PVC-U Glued sleeve PN16

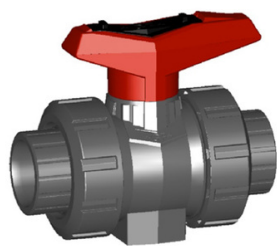

Characteristics

Series: 546

Construction type: 2-way

Housing construction: 3-part

Housing material: PVC-U

Connection: Glued sleeve

Seat material: PTFE

Nominal inner diameter	External tube diameter of connection mm	Pressure rating	Face to Face norm	Manual operation	Material ball	Primary spindle seal material	Secondary spindle seal material	Body seal	Actuator material	Article
DN10	16	PN16	Manufacturer standard	Handle	PVC-U	EPDM	EPDM	EPDM		11247594
DN10	16	PN16	Manufacturer standard	Handle	PVC-U	FPM (FKM)	FPM (FKM)	FPM (FKM)	Plastic	11247601
DN15	20	PN16	Manufacturer standard	Handle	PVC-U	EPDM	EPDM	EPDM		11247595
DN15	20	PN16	Manufacturer standard	Handle	PVC-U	FPM (FKM)	FPM (FKM)	FPM (FKM)		11247602
DN20	25	PN16	Manufacturer standard	Handle	PVC-U	EPDM	EPDM	EPDM	Plastic	11247596
DN20	25	PN16	Manufacturer standard	Handle	PVC-U	FPM (FKM)	FPM (FKM)	FPM (FKM)		11247603
DN25	32	PN16	Manufacturer standard	Handle	PVC-U	EPDM	EPDM	EPDM	Plastic	11247597
DN25	32	PN16	Manufacturer standard	Handle	PVC-U	FPM (FKM)	FPM (FKM)	FPM (FKM)		11247604
DN32	40	PN16	Manufacturer standard	Handle	PVC-U	EPDM	EPDM	EPDM		11247598
DN32	40	PN16	Manufacturer standard	Handle	PVC-U	FPM (FKM)	FPM (FKM)	FPM (FKM)		11247605
DN40	50	PN16	Manufacturer standard	Handle	PVC-U	EPDM	EPDM	EPDM	Plastic	11247599
DN40	50	PN16	Manufacturer standard	Handle	PVC-U	FPM (FKM)	FPM (FKM)	FPM (FKM)		11247606
DN50	63	PN16	Manufacturer standard	Handle	PVC-U	EPDM	EPDM	EPDM		11247600
DN50	63	PN16	Manufacturer standard	Handle	PVC-U	FPM (FKM)	FPM (FKM)	FPM (FKM)		11247607
DN65	75	PN16	Manufacturer standard	Handle	PVC-U	EPDM	EPDM	EPDM		11446660
DN80	90	PN16	Manufacturer standard	Handle	PVC-U	EPDM	EPDM	EPDM		11481791
DN100	110	PN16	Manufacturer standard	Handle	PVC-U	EPDM	EPDM	EPDM		11485739

Disclaimer: The content of this document has been composed with the utmost care. However, it is possible that certain information changes over time, becomes inaccurate or incomplete. ERIKS does not guarantee that the information provided on this document is up to date, accurate and complete; the information provided is not intended to be advice. ERIKS shall never be liable for damage resulting from the use of the information provided.