



## ASCO Solenoid valve 2/2 Type: 32302 Series: 210 Stainless steel Pilot operated hung diaphragm Normally closed (NC)

- Features/Functions like a working solenoid valve and is ideal for systems with low pressure differences and low media speeds.
- Opens from 0 bar.
- Robust design, reliable and durable.

### Characteristics

**Series:** 210

**Type:** 32302

**Function:** Normally closed (NC)

**Actuation:** Pilot operated hung diaphragm

**Minimum pressure difference:** 0 bar

**Maximum pressure difference:** 16 bar

**Electrical connection:** Plug EN 175301-803 type A

**Max. viscosity:** 65 mm<sup>2</sup>/s

**Housing material:** Stainless steel

**Material quality:** 1.4301

**Material coil housing:** Epoxy

**Material shorting ring:** Silver

**Working time:** 100 %

**Level of protection (IP value):** IP65

**Explosion-proof:** No

**SIL certified:** No

### Application

- Neutral gases. Slightly aggressive gases. Neutral liquids. Hydraulic oil. Closed circulatory systems with low pressure difference. Draining a depressurised tank. Closed circulatory systems.

### Technical Information

- Mounting in any position is permitted, but preferably with the coil facing upwards.

### Size table:

Orifice mm	Type	Size	Voltage	A mm	B mm	C mm	D mm	E mm	F mm
16	C487	1/2"	AC	86	51	30	71	45	58
16	C487	1/2"	DC	91	56	33	71	50	58
16	C488	3/4"	AC	86	51	30	71	45	58
16	C488	3/4"	DC	91	56	33	71	50	58
25	D489	1"	AC/DC	91	56	33	95	50	98

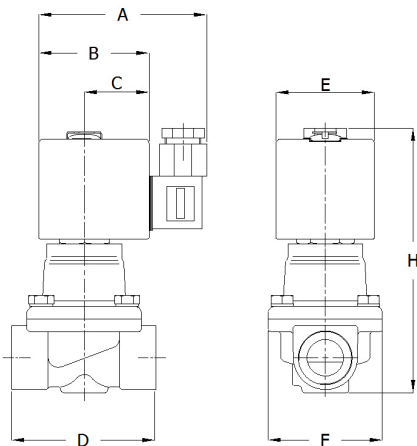

Disclaimer: The content of this document has been composed with the utmost care. However, it is possible that certain information changes over time, becomes inaccurate or incomplete. ERIKS does not guarantee that the information provided on this document is up to date, accurate and complete; the information provided is not intended to be advice. ERIKS shall never be liable for damage resulting from the use of the information provided.

Size process connection	Process connection	Orifice mm	Kvs value m <sup>3</sup> /h	Coil type	Supply voltage	Power	Starting power	Sealing	Membrane material	Article
1/2" [15]	Internal thread (BSPP)	16	3.4	400425-201	24V AC	16.7 W / 35VA	78 VA	FPM	FPM	14545766
1/2" [15]	Internal thread (NPT)	16	3.4	400425-201	24V AC	16.7 W / 35VA	78 VA	NBR	NBR	14545801
1/2" [15]	Internal thread (NPT)	16	3.4	400625-142	24V DC	12 W [hot] - 16.8 W [cold]		FPM	FPM	14545767
1/2" [15]	Internal thread (BSPP)	16	3.4	400625-142	24V DC	12 W [hot] - 16.8 W [cold]		FPM	FPM	14545769
1/2" [15]	Internal thread (NPT)	16	3.4	400425-217	230V AC	16.7 W / 35VA	78 VA	EPDM	EPDM	14545765
1/2" [15]	Internal thread (BSPP)	16	3.4	400425-217	230V AC	16.7 W / 35VA	78 VA	FPM	FPM	14545764
1/2" [15]	Internal thread (NPT)	16	3.4	400425-217	230V AC	16.7 W / 35VA	78 VA	FPM	FPM	14545768
1/2" [15]	Internal thread (NPT)	16	3.4	400425-217	230V AC	16.7 W / 35VA	78 VA	NBR	NBR	14545770
3/4" [20]	Internal thread (NPT)	16	3.9	400425-201	24V AC	16.7 W / 35VA	78 VA	FPM	FPM	14545771
3/4" [20]	Internal thread (BSPP)	16	3.9	400425-201	24V AC	16.7 W / 35VA	78 VA	FPM	FPM	14545772
3/4" [20]	Internal thread (BSPP)	16	3.9	400625-142	24V DC	12 W [hot] - 16.8 W [cold]		FPM	FPM	14545796
3/4" [20]	Internal thread (NPT)	16	3.9	400625-142	24V DC	12 W [hot] - 16.8 W [cold]		FPM	FPM	14545795
3/4" [20]	Internal thread (NPT)	16	3.9	400425-217	230V AC	16.7 W / 35VA	78 VA	FPM	FPM	14545793
3/4" [20]	Internal thread (BSPP)	16	3.9	400425-217	230V AC	16.7 W / 35VA	78 VA	FPM	FPM	14545794
1" [25]	Internal thread (NPT)	25	9.6	400525-101	24V AC	15.4 W / 33.6 VA	110 VA	FPM	FPM	14545799
1" [25]	Internal thread (BSPP)	25	9.6	400525-101	24V AC	15.4 W / 33.6 VA	110 VA	FPM	FPM	14545803
1" [25]	Internal thread (BSPP)	25	9.6	400625-242	24V DC	16.8 W [hot] - 23 W [cold]		FPM	FPM	14545802
1" [25]	Internal thread (NPT)	25	9.6	400625-242	24V DC	16.8 W [hot] - 23 W [cold]		NBR	NBR	14545800
1" [25]	Internal thread (BSPP)	25	9.6	400625-242	24V DC	16.8 W [hot] - 23 W [cold]		NBR	NBR	14545804
1" [25]	Internal thread (NPT)	25	9.6	400525-117	230V AC	15.4 W / 33.6 VA	110 VA	FPM	FPM	14545797
1" [25]	Internal thread (BSPP)	25	9.6	400525-117	230V AC	15.4 W / 33.6 VA	110 VA	FPM	FPM	14545798
1" [25]	Internal thread (BSPP)	25	9.6	400525-117	230V AC	15.4 W / 33.6 VA	110 VA	NBR	NBR	14545805

Disclaimer: The content of this document has been composed with the utmost care. However, it is possible that certain information changes over time, becomes inaccurate or incomplete. ERIKS does not guarantee that the information provided on this document is up to date, accurate and complete; the information provided is not intended to be advice. ERIKS shall never be liable for damage resulting from the use of the information provided.