



ASCO Solenoid valve 2/2 Type: 32302 Series: 210 Stainless steel Pilot operated hung diaphragm Normally closed (NC)

- Features/Functions like a working solenoid valve and is ideal for systems with low pressure differences and low media speeds.
- Opens from 0 bar.
- Robust design, reliable and durable.

Characteristics

Series: 210
Type: 32302
Function: Normally closed (NC)
Actuation: Pilot operated hung diaphragm
Electrical connection: Plug EN 175301-803 type A
Housing material: Stainless steel
Material quality: 1.4301
Material coil housing: Epoxy
Material shorting ring: Silver
Working time: 100 %
Level of protection (IP value): IP65
Explosion-proof: No
SIL certified: No

Application

- Neutral gases. Slightly aggressive gases. Neutral liquids. Hydraulic oil. Closed circulatory systems with low pressure difference. Draining a depressurised tank. Closed circulatory systems.

Technical Information

- Mounting in any position is permitted, but preferably with the coil facing upwards.

Size table:

Type	Size	Voltage	A mm	B mm	C mm	D mm	E mm	F mm	H mm
C487	1/2"	AC	86	51	30	71	45	58	119
C487	1/2"	DC	91	56	33	71	50	58	116
D489	1"	AC/DC	91	56	33	95	50	98	134
C488	3/4"	AC	86	51	30	71	45	58	119
C488	3/4"	DC	91	56	33	71	50	58	116

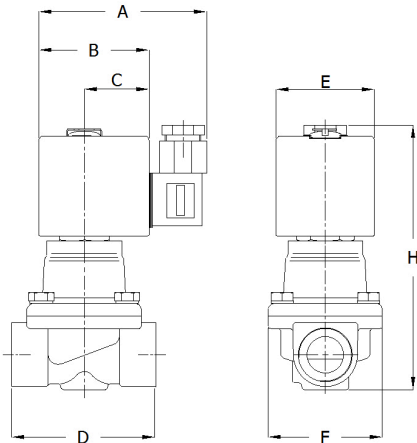

Size process connection	Process connection	Orifice mm	Kvs value m³/h	Minimum pressure difference bar	Maximum pressure difference bar	Coil type	Supply voltage	Power	Starting power	Article
										14545803

Disclaimer: The content of this document has been composed with the utmost care. However, it is possible that certain information changes over time, becomes inaccurate or incomplete. ERIKS does not guarantee that the information provided on this document is up to date, accurate and complete; the information provided is not intended to be advice. ERIKS shall never be liable for damage resulting from the use of the information provided.

Size process connection	Process connection	Orifice mm	Kvs value m ³ /h	Minimum pressure difference bar	Maximum pressure difference bar	Coil type	Supply voltage	Power	Starting power	Article
										14545802
1/2" [15]	Internal thread (BSPP)	16	3.4	0	9	400425-201	24V AC	16.7 W / 35VA	78 VA	11815161
1/2" [15]	Internal thread (BSPP)	16	3.4	0	16	400425-201	24V AC	16.7 W / 35VA	78 VA	14545766
1/2" [15]	Internal thread (NPT)	16	3.4	0	16	400425-201	24V AC	16.7 W / 35VA	78 VA	14545801
1/2" [15]	Internal thread (NPT)	16	3.4	0	16	400625-142	24V DC	12 W [hot] - 16.8 W [cold]		14545767
1/2" [15]	Internal thread (BSPP)	16	3.4	0	16	400625-142	24V DC	12 W [hot] - 16.8 W [cold]		14545769
1/2" [15]	Internal thread (NPT)	16	3.4	0	3	400425-142	24V DC	9 W [hot] - 11.2 W [cold]		11815166
1/2" [15]	Internal thread (NPT)	16	3.4	0	16	400425-217	230V AC	16.7 W / 35VA	78 VA	14545765
1/2" [15]	Internal thread (BSPP)	16	3.4	0	16	400425-217	230V AC	16.7 W / 35VA	78 VA	14545764
1/2" [15]	Internal thread (NPT)	16	3.4	0	16	400425-217	230V AC	16.7 W / 35VA	78 VA	14545768
1/2" [15]	Internal thread (BSPP)	16	3.4	0	16		230V AC	16.7 W / 35VA	78 VA	14546811
1/2" [15]	Internal thread (NPT)	16	3.4	0	16	400425-217	230V AC	16.7 W / 35VA	78 VA	14545770
1" [25]	Internal thread (NPT)	25	9.6	0	16	400525-101	24V AC	15.4 W / 33.6 VA	110 VA	14545799
1" [25]	Internal thread (BSPP)	25	9.6	0	16	400625-242	24V DC	16.8 W [hot] - 23 W [cold]		14545804
1" [25]	Internal thread (NPT)	25	9.6	0	16	400625-242	24V DC	16.8 W [hot] - 23 W [cold]		14545800
1" [25]	Internal thread (BSPP)	25	9.6	0	16	400525-117	230V AC	15.4 W / 33.6 VA	110 VA	14545798
1" [25]	Internal thread (NPT)	25	9.6	0	16	400525-117	230V AC	15.4 W / 33.6 VA	110 VA	14545797
1" [25]	Internal thread (BSPP)	25	9.6	0	16	400525-117	230V AC	15.4 W / 33.6 VA	110 VA	14545805
3/4" [20]	Internal thread (NPT)	16	3.9	0	16	400425-201	24V AC	16.7 W / 35VA	78 VA	14545771
3/4" [20]	Internal thread (BSPP)	16	3.9	0	16	400425-201	24V AC	16.7 W / 35VA	78 VA	14545772
3/4" [20]	Internal thread (BSPP)	16	3.9	0	3	400425-142	24V DC	9 W [hot] - 11.2 W [cold]		11815168
3/4" [20]	Internal thread (NPT)	16	3.9	0	16	400625-142	24V DC	12 W [hot] - 16.8 W [cold]		14545795
3/4" [20]	Internal thread (BSPP)	16	3.9	0	16	400625-142	24V DC	12 W [hot] - 16.8 W [cold]		14545796
3/4" [20]	Internal thread (NPT)	16	3.9	0	16	400425-217	230V AC	16.7 W / 35VA	78 VA	14545793
3/4" [20]	Internal thread (BSPP)	16	3.9	0	16	400425-217	230V AC	16.7 W / 35VA	78 VA	14545794

Disclaimer: The content of this document has been composed with the utmost care. However, it is possible that certain information changes over time, becomes inaccurate or incomplete. ERIKS does not guarantee that the information provided on this document is up to date, accurate and complete; the information provided is not intended to be advice. ERIKS shall never be liable for damage resulting from the use of the information provided.