



ERIKS Duplex plate wheels for two single chains 08B-1

Characteristics

Series: Platewheel PB Double

Type: 08B

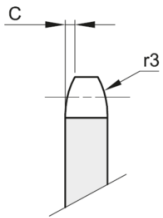
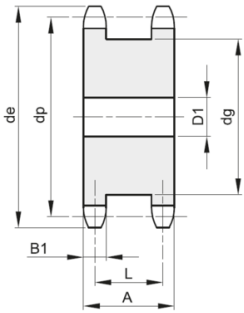

Norm	Pitch mm	Pitch in	Number of teeth	Pilot bore mm	Material	Article
DIN 8187	12.7	1/2	13		Steel C45 [1.0503]	14432432
DIN 8187	12.7	1/2	15		Steel C45 [1.0503]	14432433
DIN 8187	12.7	1/2	17		Steel C45 [1.0503]	14432434
DIN 8187	12.7	1/2	18		Steel C45 [1.0503]	14432435
DIN 8187	12.7	1/2	19		Steel C45 [1.0503]	14432436
DIN 8187	12.7	1/2	20		Steel C45 [1.0503]	14432437
DIN 8187	12.7	1/2	21		Steel C45 [1.0503]	14432438
DIN 8187	12.7	1/2	23		Steel C45 [1.0503]	14432439
DIN 8187	12.7	1/2	25		Steel C45 [1.0503]	14432440
ISO 606 - DIN 8187	12.7	1/2	12	15	Steel C45 [1.0503]	13515233
ISO 606 - DIN 8187	12.7	1/2	14	15	Steel C45 [1.0503]	13515235
ISO 606 - DIN 8187	12.7	1/2	16	15	Steel C45 [1.0503]	13515237

Disclaimer: The content of this document has been composed with the utmost care. However, it is possible that certain information changes over time, becomes inaccurate or incomplete. ERIKS does not guarantee that the information provided on this document is up to date, accurate and complete; the information provided is not intended to be advice. ERIKS shall never be liable for damage resulting from the use of the information provided.