



ERIKS Duplex plate wheels for two single chains 06B-1

Characteristics

Series: Platewheel PB Double

Type: 06B

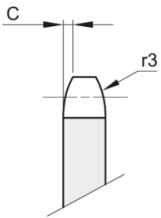
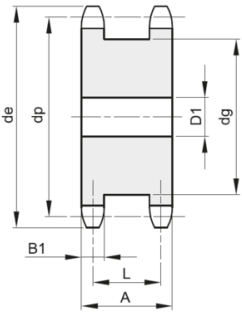

Norm	Pitch mm	Pitch in	Number of teeth	Pilot bore mm	Material	Article
DIN 8187	9.525	3/8	13		Steel C45 [1.0503]	14432423
DIN 8187	9.525	3/8	15		Steel C45 [1.0503]	14432424
DIN 8187	9.525	3/8	17		Steel C45 [1.0503]	14432425
DIN 8187	9.525	3/8	18		Steel C45 [1.0503]	14432426
DIN 8187	9.525	3/8	19		Steel C45 [1.0503]	14432427
DIN 8187	9.525	3/8	20		Steel C45 [1.0503]	14432428
DIN 8187	9.525	3/8	21		Steel C45 [1.0503]	14432429
DIN 8187	9.525	3/8	23		Steel C45 [1.0503]	14432430
DIN 8187	9.525	3/8	25		Steel C45 [1.0503]	14432431
ISO 606 - DIN 8187	9.525	3/8	14	10	Steel C45 [1.0503]	13515223
ISO 606 - DIN 8187	9.525	3/8	16	12	Steel C45 [1.0503]	13515225

Disclaimer: The content of this document has been composed with the utmost care. However, it is possible that certain information changes over time, becomes inaccurate or incomplete. ERIKS does not guarantee that the information provided on this document is up to date, accurate and complete; the information provided is not intended to be advice. ERIKS shall never be liable for damage resulting from the use of the information provided.